

Fail-secured Type Electric Deadbolt



DA-64NS

Specifications

Nominal voltage	DC12V
Standby current	18mA
Working current	440mA
Temp. range	-20°C~70°C
Power consumption	0.2W(Standby) / 5.3W(Work)
Features	<ol style="list-style-type: none">1. Drop to hold positioning by magnet.2. With magnetic switch door position sensor.3. Low working current, no over heating problem.4. With DIP switch for setting time delay for opening & relock door.5. Electric drop bolt design suitable for double swing door with 180° opening angle.6. With LED for indicating power & bolt status.
Applications	For aluminum, steel, wooden or brass door.

Accessory series

Deadbolt releaser is the device installed on the door panel to pair with the general deadbolt lock which is installed on the door jamb for auxiliary releasing the bolt during either in damaged or power failing condition. Especially for the fail safe type power bolt which is unable to release the bolt during power failure.

Deadbolt releaser

DAR-24

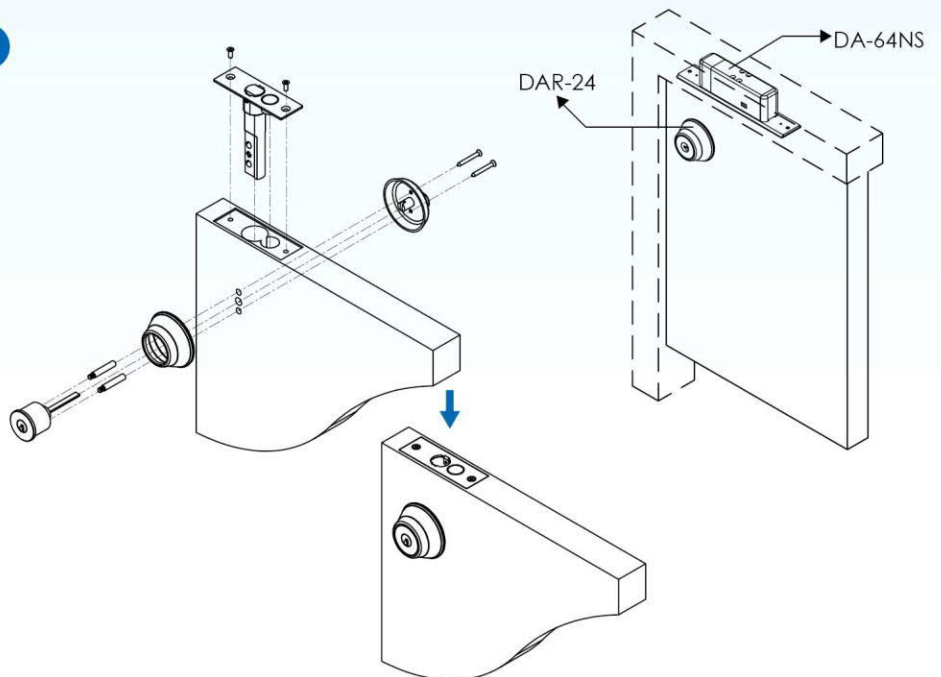

Deadbolt which is unable to release the bolt during power failure.



By(DAR-24) key or knob to open.

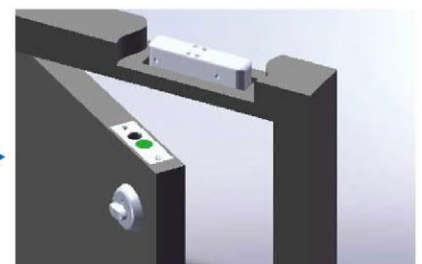

Door opened

External hanging bracket for deadbolt releaser

PG-B64K1

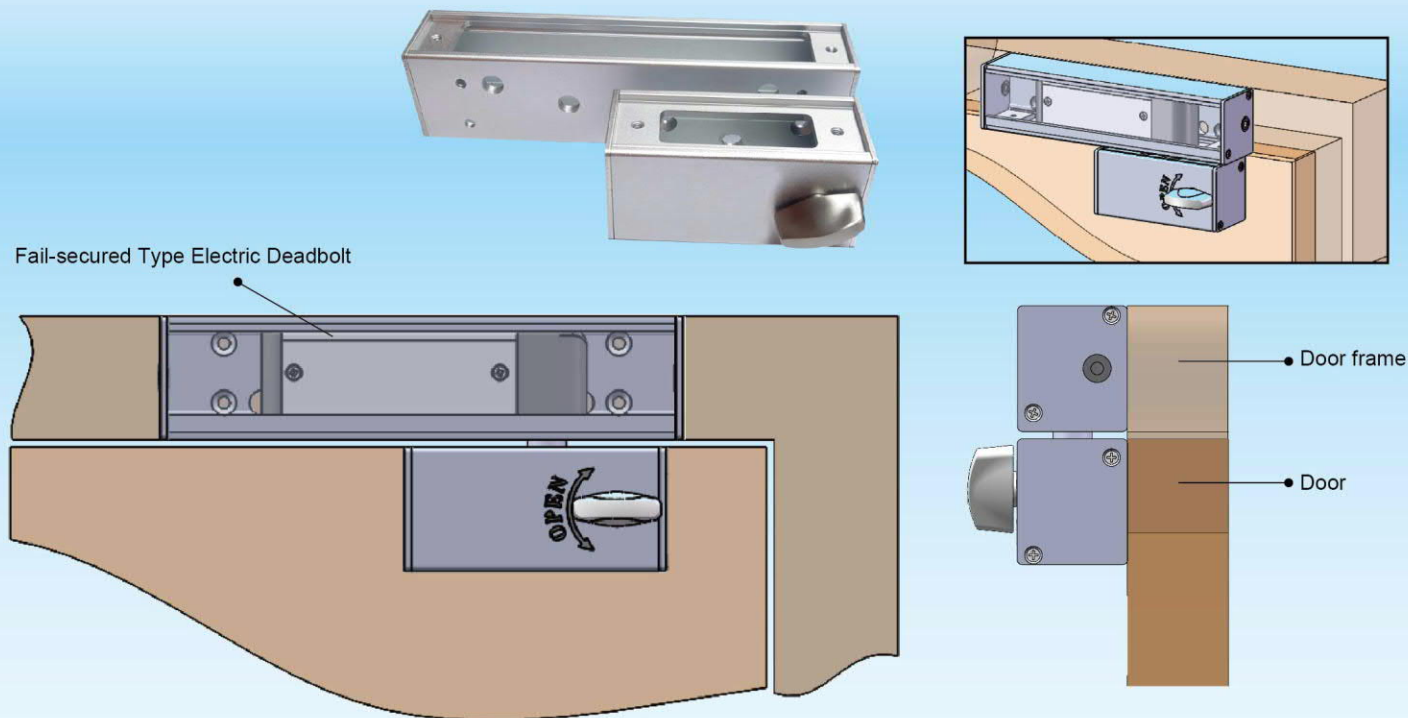

External hanging bracket for deadbolt releaser

PG-B64K2

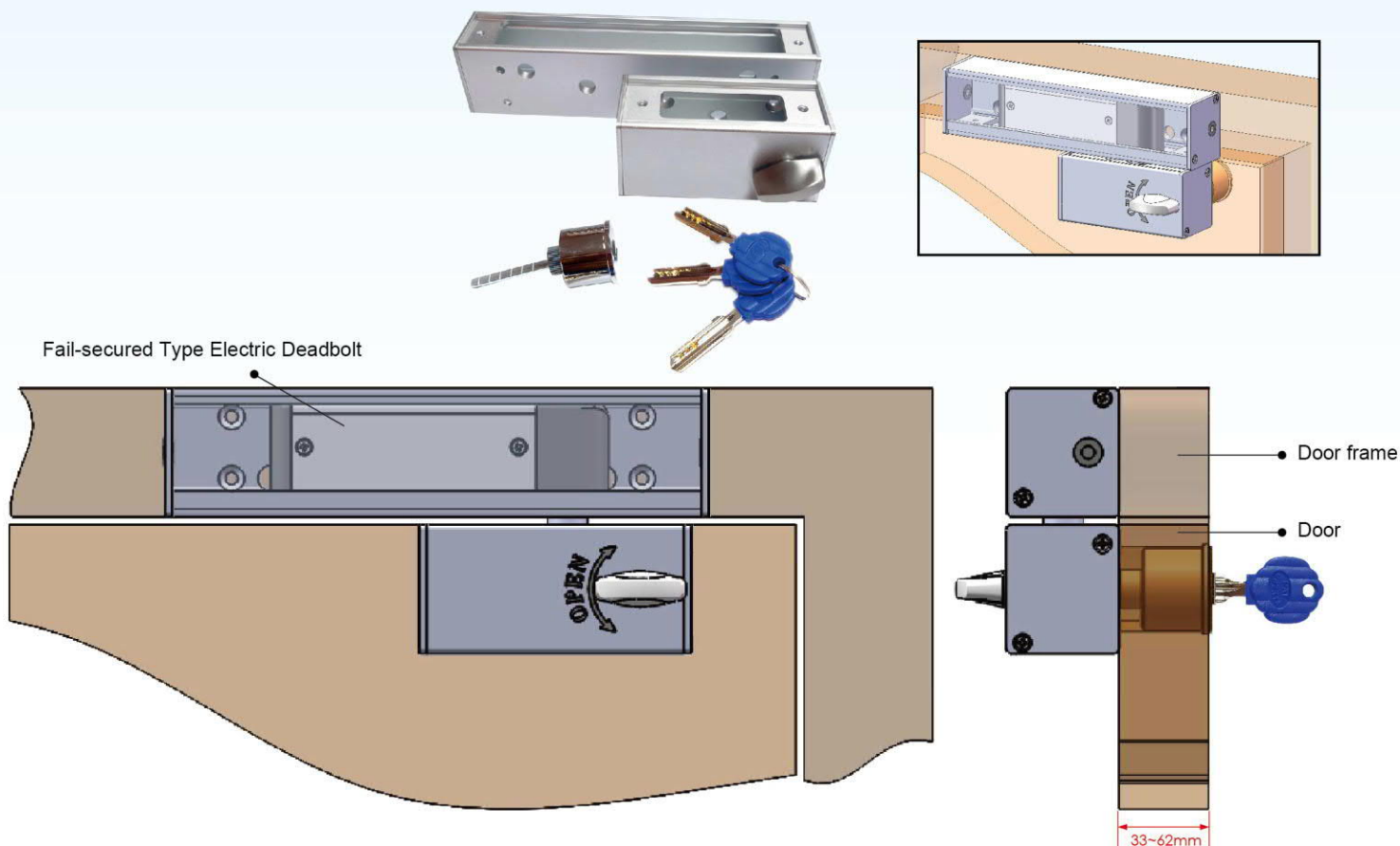

PONGEE INDUSTRIES CO., LTD.

5F., No.738, Chung-Cheng Rd., Chung-Ho District, New Taipei City 235603, Taiwan

Tel : 886-2-82280198

Fax : 886-2-82280191

E-mail : pongee@pongee.com.tw

Website: <http://www.pongee.com>

We reserve the right to change the specification without prior notice or obligation!

20250814