

Wireless push button & access for automatic doors



PWS-188L



PWS-188-TL



LED



PWS-188-R

Features:

- Adjustable releasing timer by VR.
- Dapper appearance with anti-off screw.
- With large capacity output, available to be used with autodoor, electric lock and access controller.
- Easy to install with no wiring.
- Learning code type, one access can match **40 pieces** push buttons.
- Optional transmitter. (PTX-201DF / PTX-601)

Dimension[mm]

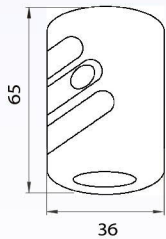

PTX-201DF



PTX-601

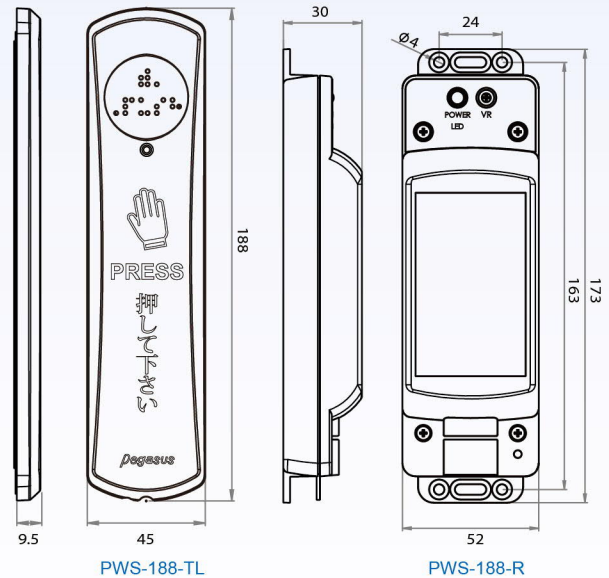

PWS-188-TL

PWS-188-R

Specification:

Wireless access for automatic doors(PWS-188-R)	
Power input	AC 100V~240V
Standby current	25mA±5%
Operating current	45mA±5%
Relay contact capacity	AC125V 0.5A / DC30V 1A
Wireless push button(PWS-188-TL)	
Power supply	DC 6V, 2 pcs battery(CR2032)
Emission current	Standby current: 0mA@6VDC Operating current: 3.2mA@6VDC
Life of battery	120,000 times
Transmit distance	Max.12m(Depending on the environment)

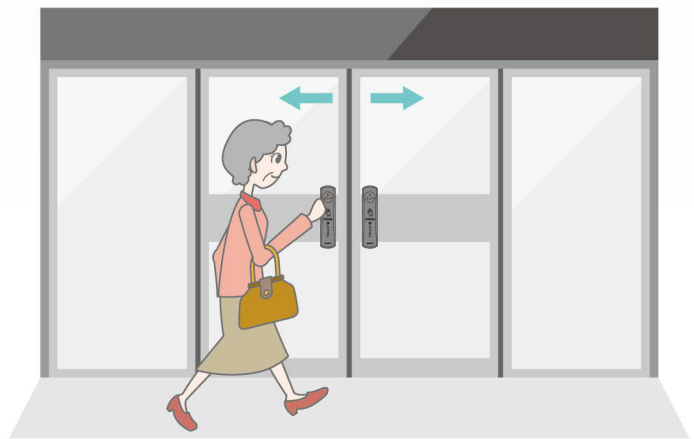

PONGEE INDUSTRIES CO., LTD.

5F., No.738, Chung-Cheng Rd., Chung-Ho District, New Taipei City 235603, Taiwan
 Tel : 886-2-82280198 Fax : 886-2-82280191
 E-mail : pongee@pongee.com.tw Website: http://www.pongee.com

We reserve the right to change the specification without prior notice or obligation!



20220314