



Remote Open Door APP

PgOpenDoor





Blue back light keypad
(Option)

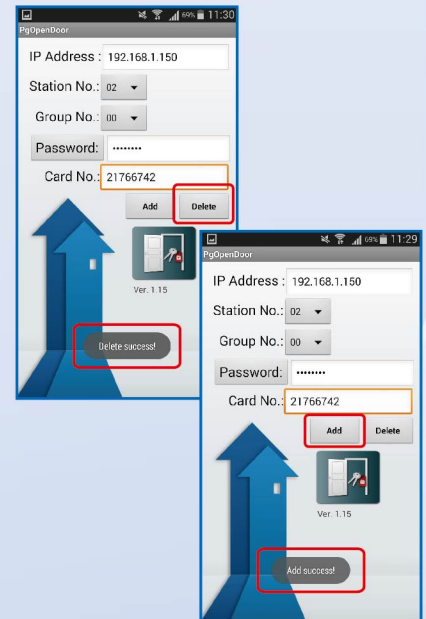

Product introduction

- The user can remote open the door by pressing 8 digits password and get the success or failure report back through PgOpenDoor APP.
- The user can remote add or delete valid card numbers and get the success or failure report back through PgOpenDoor APP.
- To add or delete plenty valid card numbers through ELE Access Control Software.
- The controller with APP function can be used together with standard 85V/6750V controllers.
- Applicable to **Android** system.





- * Remote open door by 8 digits password.
- * Add or delete valid card number one by one.



PST-ADV-E-ELE Software

PC

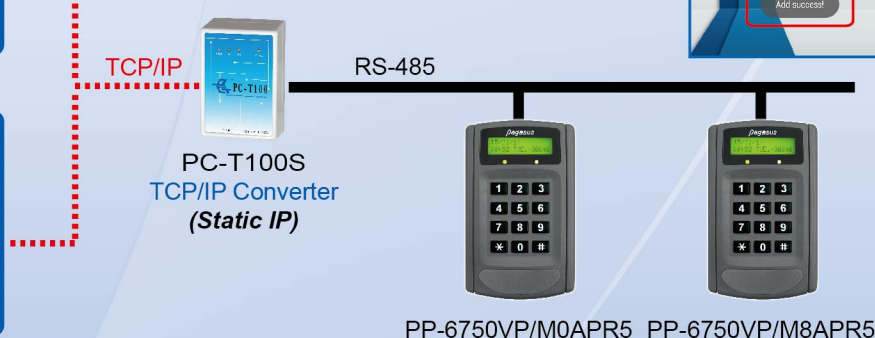

PONGEE INDUSTRIES CO., LTD.

5F., No.738, Chung-Cheng Rd., Chung-Ho District, New Taipei City 23511, Taiwan
 Tel : 886-2-82280198 Fax : 886-2-82280191
 E-mail : pongee@pongee.com.tw Website: http://www.pongee.com
 We reserve the right to change the specification without prior notice or obligation!



20170519